

1. Assign a location for the equipment considering the space requirements.
2. For wall holder assembly, refer to the sketched layout of the rear part or use it as a drilling jig. Its height and the fastening material have to be determined on site. Keep in mind a total weight of 75 kg.
3. **Attention: For fastening the effect disc, the screws slightly have to be lubricated with installation paste!** Connect outer flange ring and effect disc with six safety screws M10x25-A2. Use two washers $\phi 10,5$ -A2 per screw. It is essential to center the screws in the blind holes. **Otherwise, tilting will destroy the threads.**
5. All items with a critical fall height ≤ 600 mm must have a surrounding minimum space of at least 1,50 m measured from the outer edges of the item. It must be kept free from obstacles or sharp-edged parts a child could possibly fall onto. There is no restriction concerning the soil characteristics (acc. to EN 1176-1-Table 3).
6. Check all screw connections according to maintenance instructions after 4-5 weeks and retighten, if necessary.

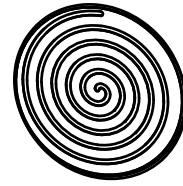

Please ensure that all special tools (e.g. Allen key for secured Allen screws etc.) and all specific documents which are or may be useful for safety management (e.g. invoice, delivery note, order acknowledgement, installation instructions, maintenance instructions) are forwarded to the persons responsible .

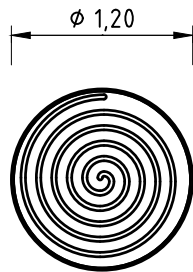

6x screw connection
safety screw M10x25-A2;
2x washer DIN 125- $\phi 10,5$ -A2

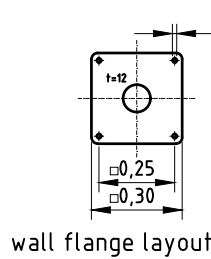

wall flange layout

